

04 January 2021

Dear Parents/Carers,

I am writing to provide more information regarding 'the rapid testing' in education that was announced recently by the government. Please be aware that we continue to receive information daily regarding the process and will strive to communicate as the situation develops.

Please see below the information provided by the government regarding who is being tested and why.

Testing is important because staff and students without symptoms could be carrying the virus and may spread it to others. Testing staff and students will support schools and colleges to operate as safely as possible.

New, simple and quick tests, known as Lateral Flow Device (LFD) tests, enable us to rapidly test students and staff, without the need for a laboratory. Secondary Schools have been provided with these test kits to conduct the testing.

In addition to frequent testing of school staff, there are two primary elements to the testing process:

1. *To test as many secondary pupils and students on their return to school and FE colleges for the spring term as possible. This means two LFDs tests being taken three to five days apart.*
Details regarding how we intend to conduct this element of the testing programme will be shared in due course.
2. *Carry out daily contact testing for seven days of pupils and students and staff who are close contacts of a positive case.*

Those identified as a close contact of someone who has tested positive will be provided with daily testing for seven days. If they test negative on a daily basis, they can continue to attend school without having to self-isolate. Please note, if consent is not given for testing, close contacts of a positive case will be required to isolate following the current government guidance and expectations.

Participating in testing is voluntary, so anybody willing to do so must consent. For students under the age of 16 require a parent/guardian consent on their behalf. **Therefore, to enable your child to take part in the testing programme, please access and complete the consent form via the following link: [LINK](#)** In doing so thus agreeing to your child's test results being shared in accordance with the Privacy Notice which can be found on the website [LINK](#) Data, including results of tests, will be stored in accordance with data protection. Please see Appendix 1 for Data Protection Frequently Asked Questions.

What does the test involve?

Students will be required to self-administer the test. Please see the process below. If you believe there are medical reasons that mean your child will be unable to do this, yet you would still like them to be part of the testing process, please notify admin@hungerhillschool.com Results of the test will be available within 30 minutes. Positive cases will be required to self-isolate in accordance with current government guidance. Close contacts of positive cases will have the option to remain in school where they will be tested daily for 7 days or self-isolate at home as stated above.

Students will be required to take a swab of the tonsils, swiping the back of the throat at least three times. They will then place the same swab gently into the nostril until they feel a slight resistance.

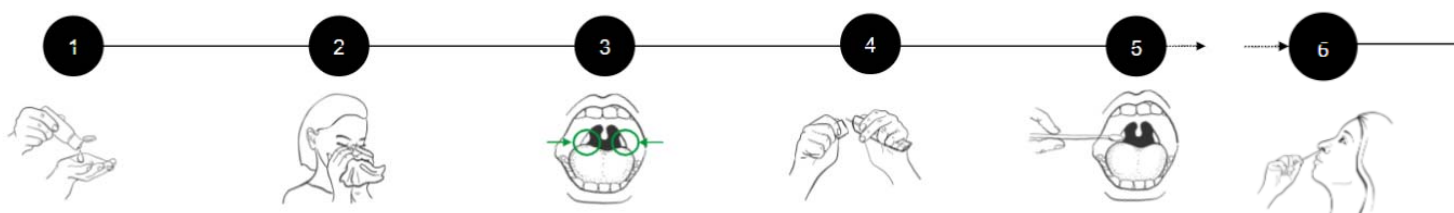

It is widely considered that this approach will support in containing the spread of Coronavirus and we urge you to consent to the testing of your child in order to keep them safe in school and to help contain the spread of the virus in our community.

Mrs L Pond

Mrs L Pond
Headteacher



National Teaching School
designated by

National College for
Teaching & Leadership



National Support School
designated by

National College for
Teaching & Leadership



Hungerhill School is part of the Brighter Futures Learning Partnership Trust
Brighter Futures Learning Partnership Trust is an exempt charity regulated by the Secretary of State for Education. It is a company limited by guarantee registered in England and Wales (Company Number 07939747), whose registered office is at Hungerhill School, Hungerhill Lane, Edenthorpe, Doncaster, DN3 2JY.